

OMM 335PM

Digital Panel Meter

PROCESS MONITOR

- Input $\pm 5\text{mA}$, $\pm 20\text{mA}$, $4\text{...}20\text{mA}$, $\pm 2\text{V}$, $\pm 5\text{V}$, $\pm 10\text{V}$
- 4-digit programmable projection
- Scaling of measured value
- Setting from PC via USB
- Linearization
- Password protection to prevent unauthorised changes of settings
- Protection IP65
- Easy mounting into standardised $\text{Ø } 22,5\text{ mm}$ hole

Note: There is galvanic connection between USB connector and input!
In case you need to configure the unit while the input signal is connected, the use of a galvanic isolated OM USB-ISO convertor is recommended.

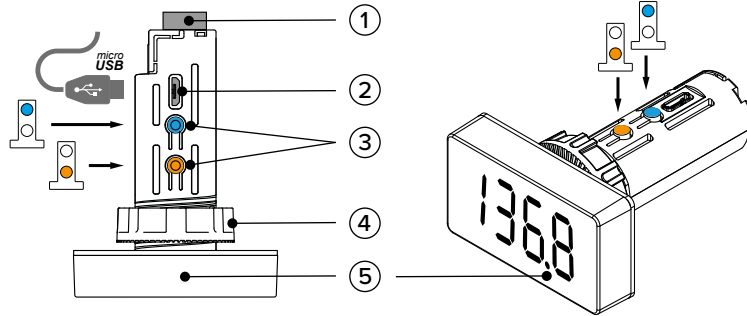

- ① Connector
- ② USB connection to PC
- ③ Interaction buttons
- ④ Fixing nut
- ⑤ 4 digit LED display

⚠ DANGER ⚠	⚠ WARNING ⚠	⚠ CAUTION
<p>HAZARD OF ELECTRIC SHOCK, EXPLOSION OR ARC FLASH</p> <p>- Disconnect all power before servicing equipment and other supply lines</p> <p>Failure to follow this instruction will result in death or serious injury.</p>	<p>EQUIPMENT OPERATION HAZARD</p> <p>- Do not use this product in safety critical system. - Do not disassemble, repair or modify this product. - Do not operate beyond the recommended operating environment.</p> <p>Failure to follow these instructions can result in death, serious injury, or equipment damage.</p>	<p>EQUIPMENT OPERATION HAZARD</p> <p>- Install 100 mA fuse UL...Class CC ; IEC...gG if unable to determine loop input current is within 4 to 20 mA</p> <p>Failure to follow this instruction can result in injury or equipment damage</p>

Electrical equipment should be installed, operated, serviced, and maintained only by qualified personnel.
No responsibility is assumed by ORBIT MERRET for any consequences arising out of the use of this material.

2 Product Connection

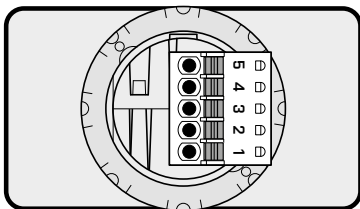

- 5 GND
- 4 Input I
- 3 Input U
- 2 Power
- 1

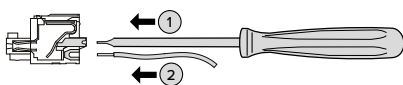

①		$\text{Ø } 2\text{ mm} / 0,08\text{ in}$
②	$\frac{\text{mm}}{\text{inch}}$	$\frac{6\text{...}8}{0,24\text{...}0,31}$
	mm^2	0,2...1,3
	AWG	24...16

Note: Contactors, high power electric motors, frequency drives and other power devices should not be in a close proximity of the meter. Input signal leads (measured value) should be separated from all power lines and power devices. Even though the meters has been designed and tested according to standards for industrial environment, we strongly advise to adhere to the above presented rules

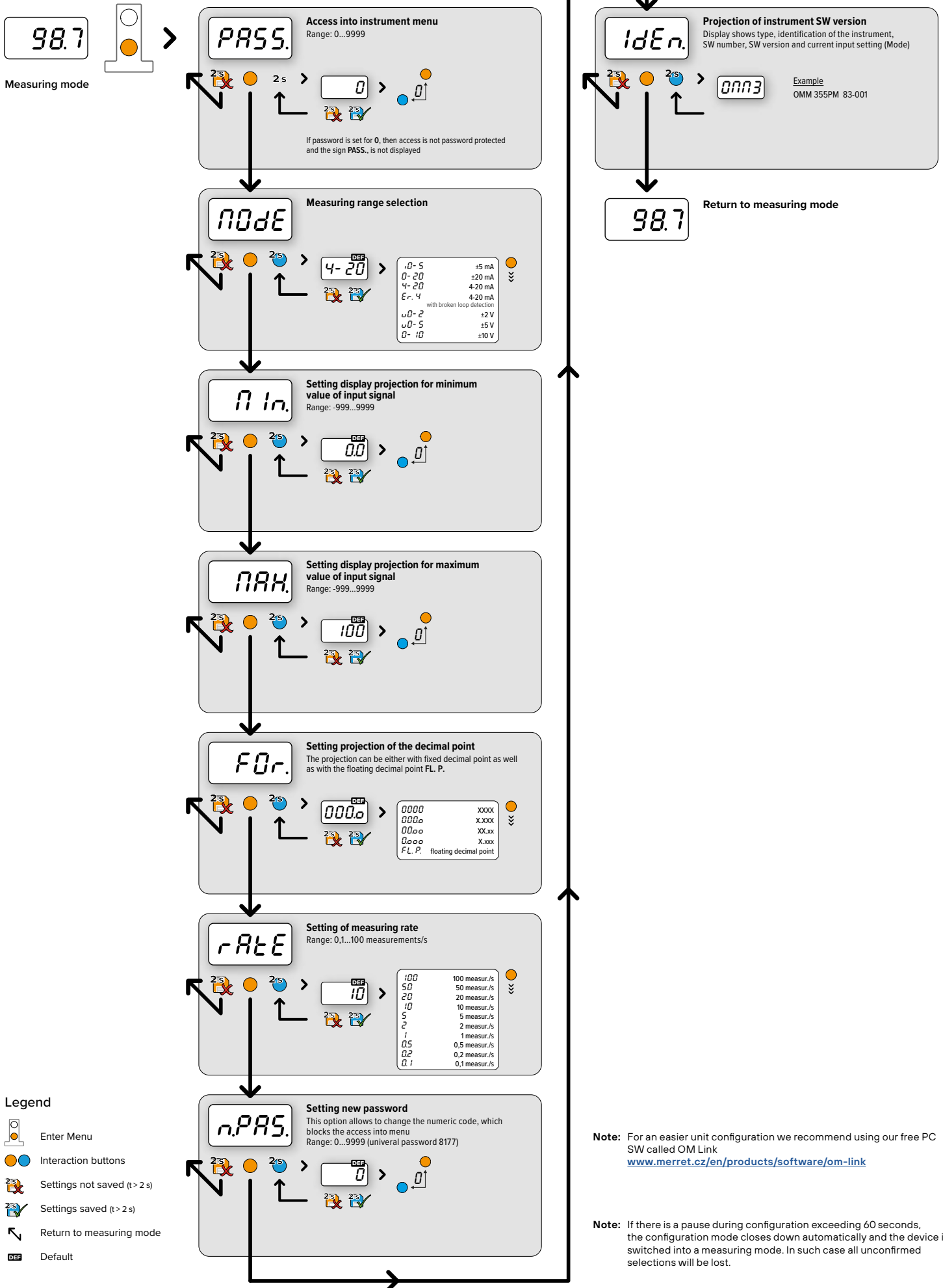

ERROR	CAUSE	ELIMINATION
$E. d_{-}$	number is too small (large negative) to be displayed	change DP setting, channel constant setting
$E. d_{+}$	number is too high to be displayed	change DP setting, channel constant setting
$E. t_{-}$	number is below the linearization table value; Error table underflow	change input signal value or linearization table
$E. t_{+}$	number is above the linearization table value; Error table overflow	change input signal value or linearization table
$E. I_n$	broken loop (measured current < 3,2 mA (range 4...20 mA))	check for loose or broken wires and screw terminals

Front view

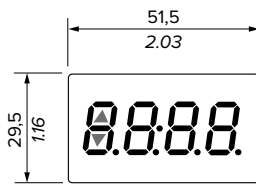

Side view

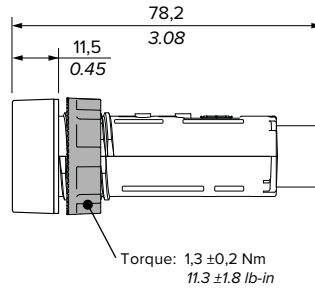

Panel cut

Panel thickness: 1..6 mm
0.04...0.24 in

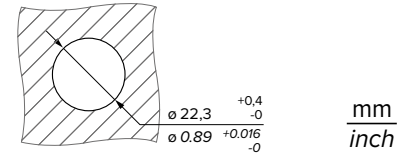

INPUT

Number of inputs	1		
Range	±5 mA	< 200 mV	Input I
	±20 mA	< 200 mV	Input I
	4...20 mA	< 200 mV	Input I
	±2 V	1 MΩ	Input U
	±5 V	1 MΩ	Input U
	±10 V	1 MΩ	Input U

PROJECTION

Display	9999, 7-segment LED
Digit height	14 mm
Display color	red or green
Projection	-999...9999
Decimal point	setting - in menu
Brightness	fixed

INSTRUMENT ACCURACY

TC	50 ppm/°C
Accuracy	±0,15% of the range + 1 digit for projection -99...1999
Rate	0,1...100 measurements/s
Overload capacity	2x
Linearizace	linear interpolation in 50 points (only via OM Link)
OM Link	company communication interface for operation, setting and update of instruments. (microUSB)
Watch-dog	reset after 500 ms
Calibration	at 25°C and 40 % r.h.

POWER SUPPLY

Power	24 VDC/24 VAC, ±10 %, 0,2 VA, 10...30 VDC/24 VAC, ±10 %, 0,2 VA, isolated
-------	--

MECHANIC PROPERTIES

Material	PA66, incombustible UL 94 V-0
Dimensions	51,5 x 29,5 x 78,2 mm
Panel cutout	ø 22,5 mm

OPERATING CONDITIONS

Connection	connector terminal blocks, section 0,2...1,3 mm ²
Stabilization period	within 5 minutes after switch-on
Working temp.	-20°...60°C
Storage temp.	-20°...85°C
Protection	IP65 (front panel only)
Construction	safety class I
El. safety	EN 61010-1, A2
Dielectric strength	700 VAC after 1 min. between power supply and signal input
Insulation resist.*	for pollution degree II, measurement cat. II power supply, input > 250 V (PI)
EMC	EN 61326-1 (Industrial area)

* PI - Primary insulation, DI - Double insulation



ORBIT MERRET, spol. s r.o.
Vodňanská 675/30
198 00 Praha 9
Czech Republic

+420 - 281 040 200 @ orbit@merret.eu

Measuring instruments of the OMM 335 series conform to the European regulation 2014/30/EU and 2014/35/EU

This product must be installed, connected and used in compliance with prevailing standards and/or installation regulations.
As standards, specifications and designs develop from time to time, always ask for confirmation of the information given in this publication.