

# Montageanleitung Positionsgeber für Winkelsensoren

## Manual Position Markers for rotary sensors

Positionsgeber Z-RFC-P01 /-P02 /-P03 /-P04 /-P07 /-P08 /-P23/-P30  
Position marker Z-RFC-P01 /-P02 /-P03 /-P04 /-P07 /-P08 /-P23/-P30

### Z-RFC-P01/-P02/-P07/-P08

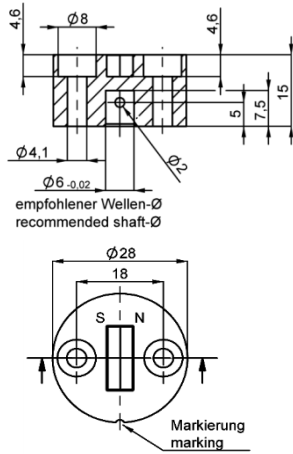

### Z-RFC-P23

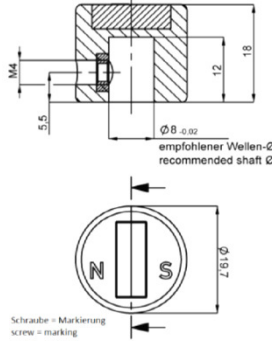

### Z-RFC-P30

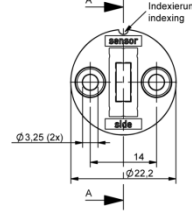

### Z-RFC-P03

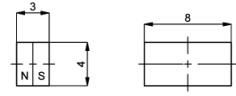
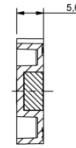

### Z-RFC-P04

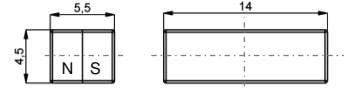

### Z-RFC-P01/-P02

**Ausführung Welle (empfohlen):**  
**Recommended shaft setup:**

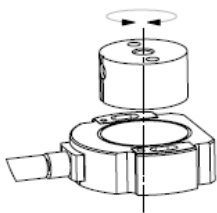
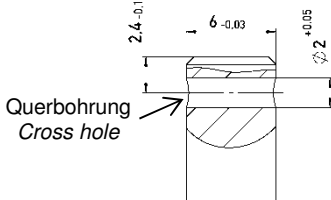

Indexpunkt / Index position  
RFC 4800+ **Z-RFC-P02**

### Z-RFC-P07/-P08/-P23

**Ausführung Welle (empfohlen):**  
**Recommended shaft setup:**

Kann unbearbeitet sein, aber eine Abflachung an der Schraubenauflage wird empfohlen.

*May be without treatment, but a flattening is recommended at screw pressing point*

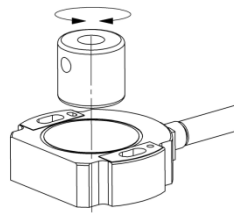

Indexpunkt / Index position  
RFC 4800+ **Z-RFC-P23**

### Z-RFC-P30

**Montagehinweise**  
**Installation instructions**

Axiale Montage mit 2 Schrauben M3 x8

*Axial mounting with 2 screws M3 x 8*

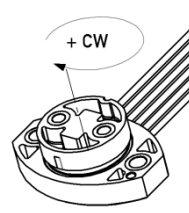

Indexpunkt / Index position  
RFD 4000+ **Z-RFC-P30**

### Z-RFC-P03 / -P04

**Montagehinweise**  
**Installation instructions**

Nicht mechanisch belasten.  
Einkleben mit anaerobem Klebstoff z.B. Weicon AN 306-30

*Avoid mechanical load. Glue in place with anaerobic glue e.g. Weicon AN 306-30*

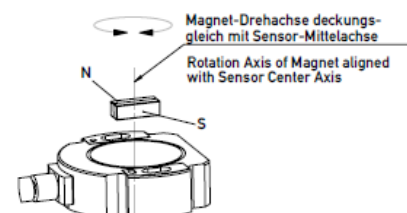

Indexpunkt / Index position  
RFC 4800+ **Z-RFC-P04**

### Montagehinweise / Installation Instructions

Bei der Montage auf einer Welle ist die Anbringung einer Querbohrung in der Welle notwendig, um den Positionsgeber mit dem mitgelieferten Schwerverspannstift zu fixieren.

*For shaft mounting please consider a cross hole in the shaft for accommodation of locking pin (included).*

*Respect maximum tightening torque (max. 300 Ncm) when fastening down the screws.*

Maximales Anzugsdrehmoment für die Gewindestifte und axiale Montage **Z-RFC-P30** ist **200 Ncm**.

*Maximum tightning torque for the headless screws and axial mounting **Z-RFC-P30** is **200 Ncm**.*

### Axiale Montage Z-RFC-P01/-P02/-P07/-P08

Bei der axialen Montage mit Befestigungsschrauben M4x20 (im Lieferumfang) ist das maximale Drehmoment von **300 Ncm** zu beachten.

### Axial mounting Z-RFC-P01/-P02/-P07/-P08

*For axial mounting with screws M4x20 (included in the delivery) the maximum tightning torque must be ≤ 300 Ncm*

Arbeitsabstände (alle Angaben in mm) working distances (in mm)	Abstand Positionsgeber zu Sensorgehäuse Distance between position marker and sensor housing							
	Positionsgeber / position marker and sensor housing							
Sensor Baureihen, Series	P01	P02	P03	P04	P07	P08	P23	P30
RFC analog / RFC digital SPI	0...1,5	0...4	0...1,5	0...4	0...1,5	0...4	0...4	-
RFC analogue / RFC digital SPI	0...1,5	0...4	0...1,5	0...4	0...1,5	0...4	0...4	-
RFC digital SSI, Incremental	0...1	0...1,5	0...1	0...1,5	0...1	0...1,5	0...1,5	-
RFA einkanalig/single	-	-	2 ± 1	4,5 ± 1,7	-	-	4,5 ± 1,7	-
RFA mehrkanalig/redundant	-	-	1,6 ± 1	4,5 ± 1,7	-	-	4,5 ± 1,7	-
RFD einkanalig/single	-	-	2 ± 1	4,5 ± 1,7	-	-	4,5 ± 1,7	1,95 ± 0,75
RFD mehrkanalig/redundant	-	-	1,6 ± 1	4,5 ± 1,7	-	-	4,5 ± 1,7	1,5 ± 0,75